



# Enzo

## 900 x 900 Corner Shower Cabin

# SEK00

SHOWER ENCLOSURES

### FEATURES

- 8mm Safety Glass
- Thermostatic Shower
- 5 Showering Options
- Real Chrome Frame
- Corner or Wall Options Available
- 5 Year Guarantee



\*Right Hand installation depicted

Logo as it appears on product:



### FINISHES AVAILABLE

Real Chrome Frame / Plain Glass

### INCLUDED COMPONENTS

#### Corner Shower Cabin

Packed Weight  
Size (palletised)

#### SEK00

Max 222Kgs  
1130 x 790 x 2260mm

### DIMENSIONS

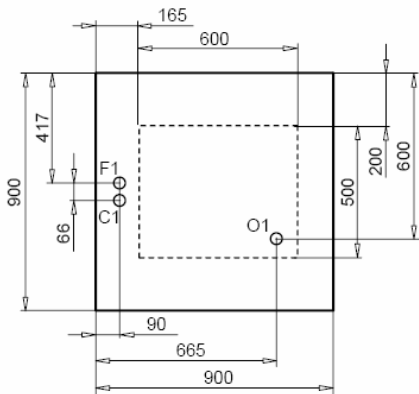

\* Drawing shows dimensions relative to left hand installation

### PRODUCT FEATURES

Special scale preventative treatment coated glass  
Fixed head and handset combines air and water for the ultimate shower experience  
Shower column features: fixed shower head, 8 body jets, thermostatic shower valve, diverter and 2 integrated fibre glass shelves.  
Showering options include: Handset only, fixed head only, fixed head and handset, fixed head and top 4 jets, 8 jets only  
Shower Tray includes 100% waterproof slatted panels.  
*Note: Shower pump not included.*

### PRODUCT DETAILS

Min/Max Operating pressure 1.5 - 2.5 bar  
Max Flow Rate (handset) 7 Lpm  
Max Flow Rate (fixed head) 9 Lpm

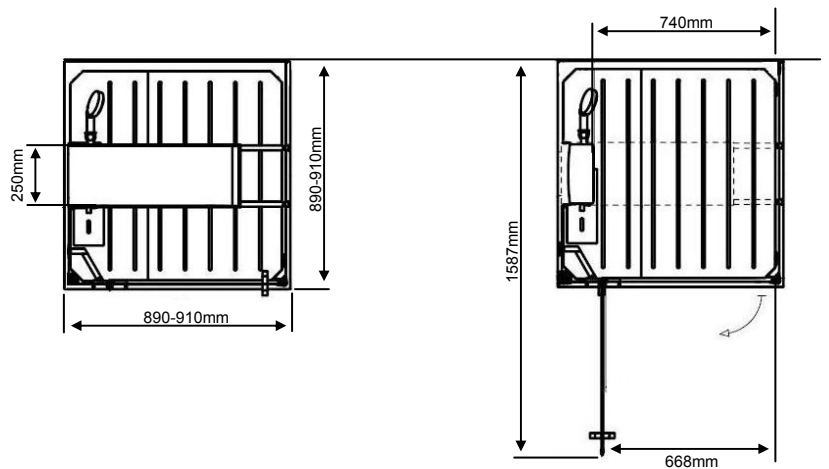
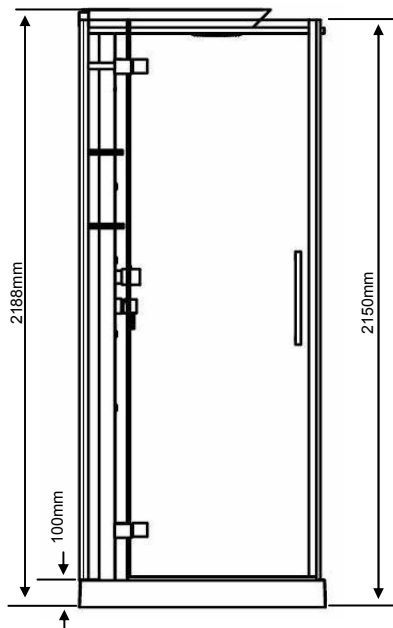

Flow rates are measured in litres per minute

|             | 1.2 | 1.5 | 2  | 2.5 | 3  |
|-------------|-----|-----|----|-----|----|
| Fixed head  | 8   | 9   | 11 | 12  | 13 |
| Handset     | 7   | 9   | 9  | 11  | 12 |
| 4 Back jets | 10  | 11  | 14 | 16  | 16 |
| 8 Back jets | 14  | 15  | 16 | 18  | 21 |